

Environmental Impact Statement

Readymix Holdings Pty Ltd
Proposed Lynwood Quarry, Marulan

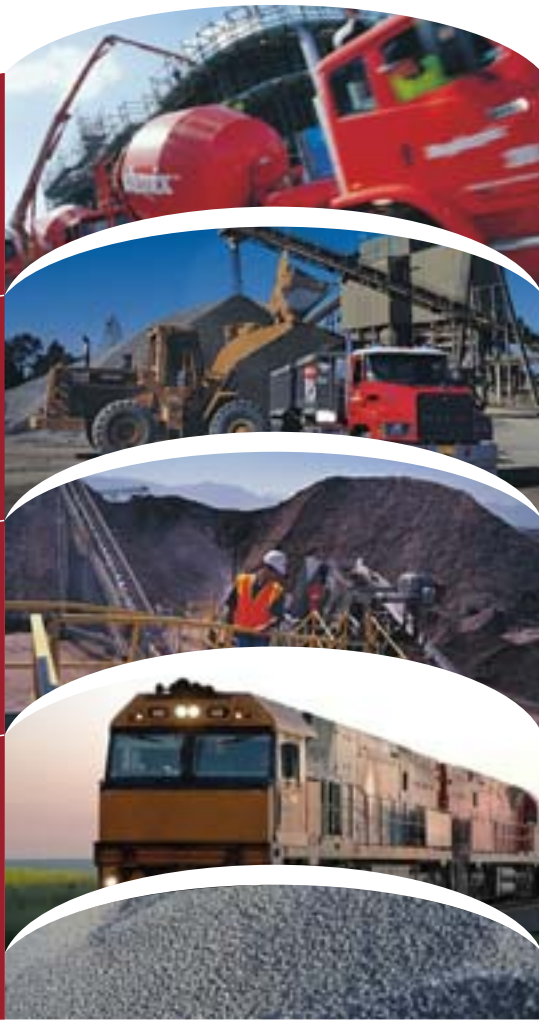

VOLUME 2
APPENDICES 1 TO 6

MAY 2005

Umwelt
Environmental Consultants

VOLUME 1

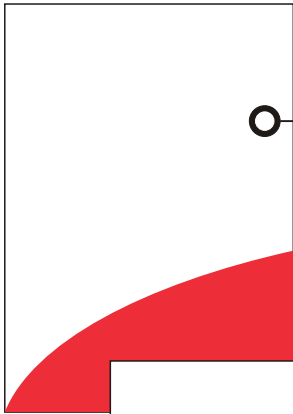

Executive Summary
Main Text

VOLUME 2



Appendices 1 to 6
1. Project Team, EIS Form & Land Schedule
2. Authority Correspondence
3. Socio-Economic Assessment
4. Soils Analyses
5. Air Quality Assessment
6. Traffic Assessment

VOLUME 3

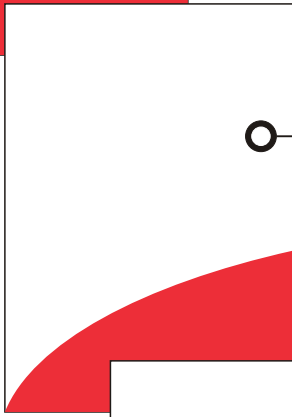

Appendices 7 to 9
7. Groundwater Assessment
8. Surface Water Management
9. Ecology Assessment

VOLUME 4



Appendices 10 to 12
10. Noise & Blasting Assessment
11. Aboriginal Archaeology Assessment
12. Historic Heritage Assessment

CONTENTS OF VOLUME 2

- Appendices 1 to 6
 - Project Team, EIS Form & Land Schedule
 - Authority Correspondence
 - Socio-Economic Assessment
 - Soils Analyses
 - Air Quality Assessment
 - Traffic Assessment





APPENDIX 1

Project Team, EIS Form
& Land Schedule

Project Team

Project Team

Umwelt (Australia) Pty Limited – EIS Preparation

Barbara Crossley B.Nat.Res.(Hons)	Project Director, Consultation, EIS Review
John Merrell B. Env. Sc.	Project Manager, Community and Agency Consultation, Report Writing, General Environmental Assessment
Luke Bettridge B.Env.Sc.	Report Writing, General Environmental Assessment
Peter Jamieson B.E (Civil)	Surface Water Assessment
Susan Shield B.E. (Hons), M.E. (Water), MIEAust CPEng	Surface Water Assessment
Andrew Goodwin B.E (Env)	Surface Water Assessment
Catherine Pepper B.E. (Hons 1), B.A.	Surface Water Assessment
Travis Peake B.Nat.Res. (Hons)	Ecological Assessment
Allison Riley B.Sc.	Ecological Assessment
Steven Cox B.App.Sci. (Hons)	Ecological Assessment
Rebecca Vere B.Sc. (Hons), M. Env. Mgt Ecologist	Ecological Assessment
Jan Wilson B.A. (Hons)	Aboriginal Archaeology Assessment
Graham Houghton B.A. (Hons)	Aboriginal Archaeology Assessment
Sue Singleton B.Sc.	Historic Heritage Assessment
Rachel Heath B.Sc.	Hazard Assessment, Bushfire Assessment
David Blyth B.Econ., Grad.Dip.Plann&Des., M.Env.St.	Greenhouse and Energy Assessment
Rebecca Abbott	Preparation of plans, figures, maps and 3D quarry plans
Belinda McLeod	Report review, formatting and quality control
Ian Kennedy	Graphic Design

Specialist investigations

Richard Heggie and Associates	Noise and Blasting Assessment
Holmes Air Sciences	Air Quality Assessment
Peter Dundon and Associates	Groundwater Assessment
Coakes Consulting	Community Involvement Program and Socio-Economic Assessment
Transport & Urban Planning	Traffic Assessment
Bell Cochrane and Associates	Geological Investigations and Quarry Planning
Asset Geotechnical	Soil Survey

Readymix Holdings Pty Ltd

The assistance of the following Readymix personnel during preparation of this EIS is gratefully acknowledged. A number of personnel from this organisation provided details regarding the project and participated in community and authority liaison.

John Hann	Project Director
Michael Heath	Project Manager
Richard Savage	Project Management and Quarry Planning
David Thomas	Processing & Infrastructure Engineer

EIS Form

**Submission of
environmental impact statement (EIS)**

prepared under the Environmental Planning and Assessment Act 1979
Section 78A (8)

EIS prepared by

Name:
Qualifications:

Address:

Barbara Crossley
B. Nat Res. (Hons)

Umwelt (Australia) Pty Limited
PO Box 838
Toronto 2283

in respect of

Proposed Lynwood Quarry

development application

Applicant Name
Applicant Address

Readymix Holdings Pty Limited
PO Box 5697
West Chatswood 1515

Land to be developed:
lot no, DP/MPS, vol/fol etc

Refer to attached Schedule 1

Proposed Development

Proposed hard rock quarry and associated processing
and transportation facilities.

or

map(s) attached.

an environmental impact statement (EIS) is attached

**environmental impact
statement**

certificate

I certify that I have prepared the contents of this
Statement and to the best of my knowledge

- it is in accordance with clauses 72 and 73 of the
*Environmental Planning and Assessment Regulation
2000*, and
- it is true in all material particulars and does not, by
its presentation or omission of information,
materially mislead.

Signature:
Name:
Date:

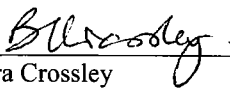

Barbara Crossley
17 May 2005

Land Schedule

Schedule 1

Refer to Figure 1.3 of the Main Text of this EIS and Figure 1 (this appendix) for property identification numbers.

Property ID	Lot	DP	Owner
1	230	750029	READYMIX HOLDINGS PTY LTD
2	3	1036993	READYMIX HOLDINGS PTY LTD
3	3	1074819	READYMIX HOLDINGS PTY LTD
4	2	1074819	READYMIX HOLDINGS PTY LTD
5	1	1074819	READYMIX HOLDINGS PTY LTD
6	4	1036993	READYMIX HOLDINGS PTY LTD
7	112	750029	READYMIX HOLDINGS PTY LTD
8	229	750029	READYMIX HOLDINGS PTY LTD
9	7	588696	READYMIX HOLDINGS PTY LTD
10	10	700579	DCO NOMINEES PTY LIMITED (Readymix Holdings Pty Ltd)
11	294	750029	DCO NOMINEES PTY LIMITED (Readymix Holdings Pty Ltd)
88	1	1074819	READYMIX HOLDINGS PTY LTD
139	7001	1025603	Crown Land
140		2153-3040	Crown Land
141	0	0	Crown Land
142	11	196132	DCO NOMINEES PTY LIMITED (Readymix Holdings Pty Ltd)
143	10	196132	DCO NOMINEES PTY LIMITED (Readymix Holdings Pty Ltd)
144	9	196132	DCO NOMINEES PTY LIMITED (Readymix Holdings Pty Ltd)
145	12	196132	DCO NOMINEES PTY LIMITED (Readymix Holdings Pty Ltd)
146	8	196132	DCO NOMINEES PTY LIMITED (Readymix Holdings Pty Ltd)
147	7	196132	DCO NOMINEES PTY LIMITED (Readymix Holdings Pty Ltd)
148	13	196132	DCO NOMINEES PTY LIMITED (Readymix Holdings Pty Ltd)
149	6	196132	DCO NOMINEES PTY LIMITED (Readymix Holdings Pty Ltd)
150	5	196132	DCO NOMINEES PTY LIMITED (Readymix Holdings Pty Ltd)
151	14	196132	DCO NOMINEES PTY LIMITED (Readymix Holdings Pty Ltd)
152	4	196132	DCO NOMINEES PTY LIMITED (Readymix Holdings Pty Ltd)
153	3	196132	DCO NOMINEES PTY LIMITED (Readymix Holdings Pty Ltd)
154	15	196132	DCO NOMINEES PTY LIMITED (Readymix Holdings Pty Ltd)
155	2	196132	DCO NOMINEES PTY LIMITED (Readymix Holdings Pty Ltd)
156	1/8	758653	THE STATE OF NEW SOUTH WALES
157	10	111641	DCO NOMINEES PTY LIMITED (Readymix Holdings Pty Ltd)
158	5/12	758653	READYMIX HOLDINGS PTY LTD
159	4/12	758653	READYMIX HOLDINGS PTY LTD
160	3/12	758653	READYMIX HOLDINGS PTY LTD
161	2/12	758653	READYMIX HOLDINGS PTY LTD
162	1/12	758653	READYMIX HOLDINGS PTY LTD
163	6/7	758653	READYMIX HOLDINGS PTY LTD
164	5/7	758653	READYMIX HOLDINGS PTY LTD
165	4/7	758653	READYMIX HOLDINGS PTY LTD
166	3/7	758653	READYMIX HOLDINGS PTY LTD
167	2/7	758653	READYMIX HOLDINGS PTY LTD

Property ID	Lot	DP	Owner
168	1/7	758653	READYMIX HOLDINGS PTY LTD
169	9/7	758653	READYMIX HOLDINGS PTY LTD
170	8/7	758653	READYMIX HOLDINGS PTY LTD
171	7/7	758653	READYMIX HOLDINGS PTY LTD
172	11	111641	DCO NOMINEES PTY LIMITED (Readymix Holdings Pty Ltd)
173	14	797340	DCO NOMINEES PTY LIMITED (Readymix Holdings Pty Ltd)
174	2	214304	JOHN FELTHAM, SHIRLEY MARGARET FELTHAM
175	1	214304	ROADS AND TRAFFIC AUTHORITY OF NEW SOUTH WALES
176	13	797340	DCO NOMINEES PTY LIMITED (Readymix Holdings Pty Ltd)
177	PT8/1	758653	JOHN FELTHAM, SHIRLEY MARGARET FELTHAM
178	PT7/1	758653	ROADS AND TRAFFIC AUTHORITY OF NEW SOUTH WALES
179	12	797340	DCO NOMINEES PTY LIMITED (Readymix Holdings Pty Ltd)
180	11	797340	DCO NOMINEES PTY LIMITED (Readymix Holdings Pty Ltd)
181	10	797340	DCO NOMINEES PTY LIMITED (Readymix Holdings Pty Ltd)
182	9	797340	DCO NOMINEES PTY LIMITED (Readymix Holdings Pty Ltd)
183	8	797340	DCO NOMINEES PTY LIMITED (Readymix Holdings Pty Ltd)
184	7	797340	DCO NOMINEES PTY LIMITED (Readymix Holdings Pty Ltd)
185	7002	1025604	Crown Land
186	6	797340	DCO NOMINEES PTY LIMITED (Readymix Holdings Pty Ltd)
187	5	797340	DCO NOMINEES PTY LIMITED (Readymix Holdings Pty Ltd)
188	4	797340	DCO NOMINEES PTY LIMITED (Readymix Holdings Pty Ltd)
189	3	797340	DCO NOMINEES PTY LIMITED (Readymix Holdings Pty Ltd)
190	2	797340	DCO NOMINEES PTY LIMITED (Readymix Holdings Pty Ltd)
191	1	797340	DCO NOMINEES PTY LIMITED (Readymix Holdings Pty Ltd)
192	4/5	758653	DCO NOMINEES PTY LIMITED (Readymix Holdings Pty Ltd)
193	3/5	758653	DCO NOMINEES PTY LIMITED (Readymix Holdings Pty Ltd)
194	2/5	758653	DCO NOMINEES PTY LIMITED (Readymix Holdings Pty Ltd)
195	1/5	758653	Crown Land
196	10/10	7586653	Crown Land
			Part Stoney Creek Road
			Part Main Southern Railway
			Part Hume Highway
			Part Marulan South Road
			Part Jerrara Road
			Part Joarimin Creek

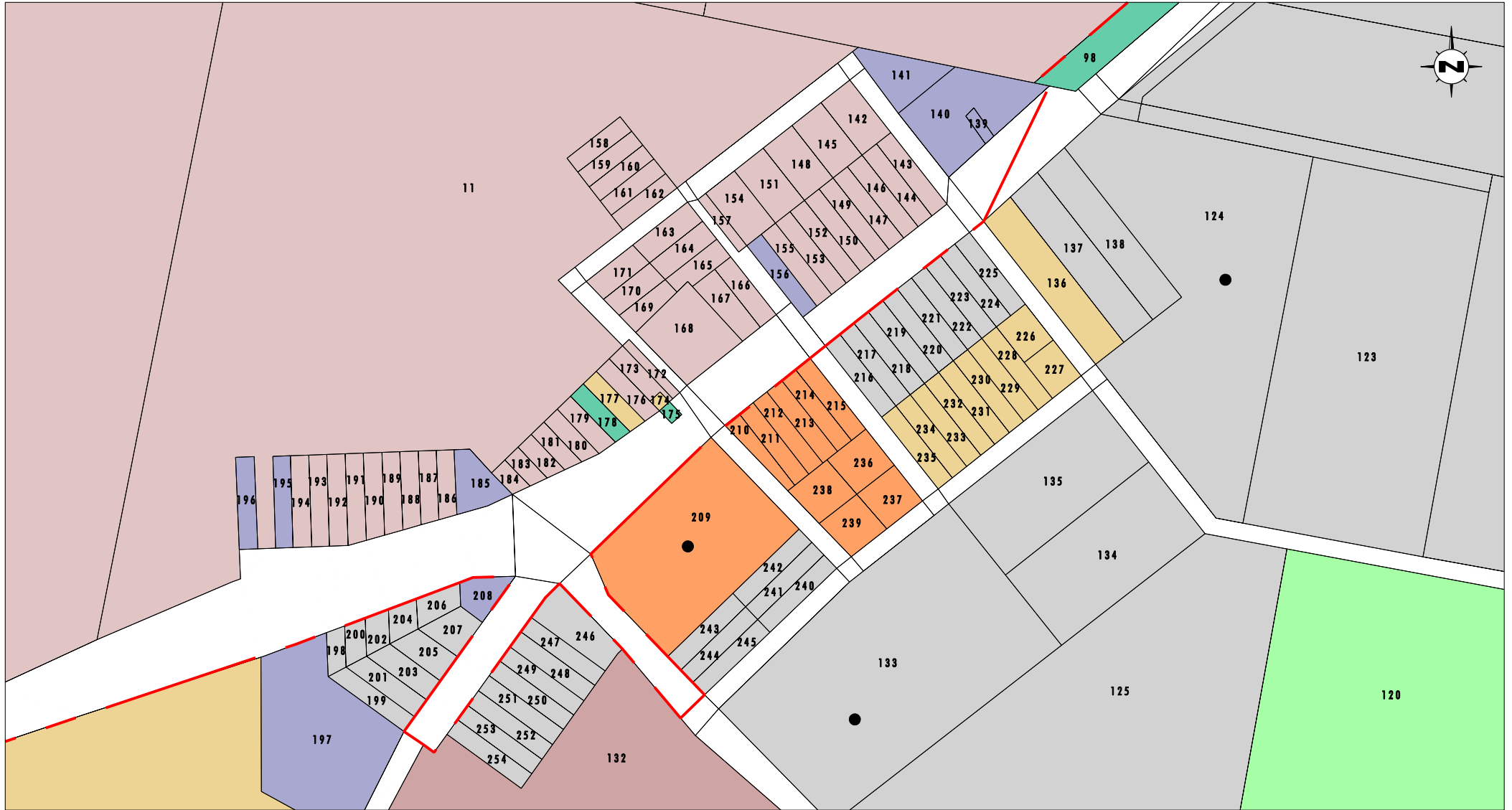

Base Source: LPI 2004, Readymix Holdings Pty Ltd

0 100 200 300m

- Legend**
- Project Area
 - Residence
 - Readymix Holdings
 - Crown Land
 - RTA
 - Other Private Land

FIGURE 1

Land Ownership - Old Marulan Township Area

Property Ownership

Property Ownership Details

Refer to Figure 1.3 of the Main Text of this EIS and Figure 1 (this appendix) for property identification numbers.

Property Identification Number	Lot	DP	Parish	County	Owner
1	230	750029	MARULAN	ARGYLE	READYMIX HOLDINGS PTY LTD
2	3	1036993	MARULAN, URINGALLA	ARGYLE	READYMIX HOLDINGS PTY LTD
3	3	1074819	MARULAN, URINGALLA	ARGYLE	READYMIX HOLDINGS PTY LTD
4	2	1074819	MARULAN	ARGYLE	READYMIX HOLDINGS PTY LTD
5	1	1074819	MARULAN	ARGYLE	READYMIX HOLDINGS PTY LTD
6	4	1036993	MARULAN	ARGYLE	READYMIX HOLDINGS PTY LTD
7	112	750029	MARULAN	ARGYLE	READYMIX HOLDINGS PTY LTD
8	229	750029	MARULAN	ARGYLE	READYMIX HOLDINGS PTY LTD
9	7	588696	MARULAN	ARGYLE	READYMIX HOLDINGS PTY LTD
10	10	700579	MARULAN	ARGYLE	DCO NOMINEES PTY LIMITED (Readymix Holdings Pty Ltd)
11	294	750029	MARULAN	ARGYLE	DCO NOMINEES PTY LIMITED (Readymix Holdings Pty Ltd)
12	1	818813	MARULAN	ARGYLE	JOHN BRUCE DUGAN, MICHAEL BRUCE DUGAN, DEREK JOHN DUGAN, KATHERINE ANNE DUGAN, JOANNE PATRICIA DUGAN
13	2	574255	NATTERY	ARGYLE	WILLIAM A. RANKEN INVESTMENTS PTY LIMITED
14	1	574255	BILLYRAMBIJA, NATTERY	ARGYLE	JEAN L. ONIONS INVESTMENTS PTY. LIMITED
15	40	750003	BILLYRAMBIJA	ARGYLE	JEAN L. ONIONS INVESTMENTS PTY. LIMITED
16	24	750003	BILLYRAMBIJA	ARGYLE	WILLIAM A. RANKEN INVESTMENTS PTY LIMITED
17	19	750003	BILLYRAMBIJA	ARGYLE	WILLIAM A. RANKEN INVESTMENTS PTY LIMITED
18	32	750003	BILLYRAMBIJA	ARGYLE	WILLIAM A. RANKEN INVESTMENTS PTY LIMITED
19	55	750003	BILLYRAMBIJA	ARGYLE	WILLIAM A. RANKEN INVESTMENTS PTY LIMITED
20	35	750003	BILLYRAMBIJA	ARGYLE	WILLIAM A. RANKEN INVESTMENTS PTY LIMITED
21	72	750003	BILLYRAMBIJA	ARGYLE	WILLIAM A. RANKEN INVESTMENTS PTY LIMITED
22	65	750003	BILLYRAMBIJA	ARGYLE	WILLIAM A. RANKEN INVESTMENTS PTY LIMITED
23	75	750003	BILLYRAMBIJA	ARGYLE	WILLIAM A. RANKEN INVESTMENTS PTY LIMITED

Property Identification Number	Lot	DP	Parish	County	Owner
24	73	750003	BILLYRAMBIJA, URINGALLA	ARGYLE	WILLIAM LAURENCE TOOTH
25	260	750053	BILLYRAMBIJA, URINGALLA	ARGYLE	WILLIAM LAURENCE TOOTH
26	214	750053	URINGALLA	ARGYLE	ROCCO OLIVERI, KATHLEEN JOAN OLIVERI
27	215	750053	URINGALLA	ARGYLE	ROCCO OLIVERI, KATHLEEN JOAN OLIVERI
28	3	841147	URINGALLA	ARGYLE	GIOVANNI D'APRILE, LUCIA D'APRILE
29	4	841147	URINGALLA	ARGYLE	ALEXANDRA HOWARD
30	2	589965	URINGALLA	ARGYLE	ROCCO OLIVERI, KATHLEEN JOAN OLIVERI
31	2	553787	URINGALLA	ARGYLE	WILLIAM PETER GRANT DAVIES
32	1	771123	URINGALLA	ARGYLE	WILLIAM PETER GRANT DAVIES
33	43	882293	URINGALLA	ARGYLE	WILLIAM PETER GRANT DAVIES
34	40	882293	URINGALLA	ARGYLE	ABU BADER
35	44	882293	URINGALLA	ARGYLE	WILLIAM PETER GRANT DAVIES
36	2	834993	URINGALLA	ARGYLE	STANLEY ALFRED SMITH, GINETTE LARAIN SMITH
37	1	834993	URINGALLA	ARGYLE	M.G. & R. SWITZER PTY LIMITED
38	117	750053	URINGALLA	ARGYLE	VIMALA NAYANAR, VENUG OPIL NAYANAR
39	118	750053	URINGALLA	ARGYLE	VIMALA NAYANAR, VENUG OPIL NAYANAR
40	294	750053	URINGALLA	ARGYLE	VIMALA NAYANAR, VENUG OPIL NAYANAR
41	1	868065	URINGALLA	ARGYLE	PETER ALLAN LOCKWOOD, CARLA ANN LOCKWOOD
42	2	868065	URINGALLA	ARGYLE	BENITO ANTONIO CARBONE, PETER ANTHONY CARBONE
43	PT246	750053	URINGALLA	ARGYLE	COLIN BEATTIE, CATHERINE ANNE BEATTIE
44	1	589965	URINGALLA	ARGYLE	IAN ALEXANDER CAMERON, MAUREEN MAY CAMERON
45	2	807146	URINGALLA	ARGYLE	LYNETTE MARIE NEVILLE
46	5	825116	URINGALLA	ARGYLE	SAM MURDOCCA, FRANK MURDOCCA, GINO TRIMARCHI
47	1	610063	URINGALLA	ARGYLE	EAST AUSTRALIAN PIPELINE LIMITED
48	6	825116	URINGALLA	ARGYLE	DENNIS JOHN STAPLETON, DAVID PATRICK NICHOLLS, STEPHEN LLOYD JOHNSON
49	4	807146	URINGALLA	ARGYLE	GRANT MORGAN, CHRISTINE ANNE WHITE
50	7	825116	URINGALLA	ARGYLE	NICK MOURGELAKIS

Property Identification Number	Lot	DP	Parish	County	Owner
51	1	1036993	MARULAN, URINGALLA	ARGYLE	SOUTH CREEK DAIRY PTY. LIMITED (Note: recently subdivided - new property details not available at time of EIS preparation)
52	7001	1029650	URINGALLA	ARGYLE	Crown Land
53	297	750053	URINGALLA	ARGYLE	REFERENCE NOT HELD
54	5	713126	URINGALLA	ARGYLE	CROSBY & SONS (MARULAN) PTY. LIMITED
55	4	713126	URINGALLA	ARGYLE	GORDON RICHARD LAWRENCE BRYANT, DIANA VIOLET BRYANT
56	1	713126	URINGALLA	ARGYLE	FRANK BEZZINA, JOHN JOSEPH BEZZINA
57	2	713126	URINGALLA	ARGYLE	JOHN JOSEPH BEZZINA
58	3	713126	URINGALLA	ARGYLE	MARIO BELTRAME, LEONIDA MARIA BELTRAME
59	2	832245	URINGALLA	ARGYLE	FRANK, LES, PAUL, BEVERLY, ANTHONY JURY
60	1	832245	URINGALLA	ARGYLE	KARL LEONARD BUSH, LEANNE ROSE BUSH
61	PT1	780918	URINGALLA	ARGYLE	Owned by Development Implementation Pty Ltd
62	PT9	17363	MARULAN	ARGYLE	Owned by John Edward Sieler
63	2	875459	MARULAN	ARGYLE	COUNCIL OF MULWAREE
64	1	1000945	MARULAN	ARGYLE	MULWAREE COUNCIL
65	4	873286	MARULAN	ARGYLE	DARYL MICHAEL BRYANT, CHERYL BRYANT
66	3	873286	MARULAN	ARGYLE	ERROL D'MELLO, JOANN HUTSON
67	2	873286	MARULAN	ARGYLE	JOSEPH MARK CHALHOUB, REGINA WILHELMINA MARIA CHALHOUB
68	1	873286	MARULAN	ARGYLE	TREVOR JOHN TIDYMAN
69	5	873286	MARULAN	ARGYLE	MARK ANTHONY SHEPHERD, EVELYN GAIL SHEPHERD
70	6	873286	MARULAN	ARGYLE	ANTHONY BRINCAT, CAROL BRINCAT
71	7	873286	ARGYLE	MARULAN	KIM MICHELLE HALL, FRANCIS DUDLEY HALL
72	8	873286	MARULAN	ARGYLE	ASSOCIAZIONE ST. SEBASTIANO MARTIRE DA CERAMI (ENNA) IN SYDNEY LIMITED
73	9	1016235	MARULAN	ARGYLE	JOHN KEVIN HURRY, LEONIE ELIZABETH HURRY
74	10	1016235	MARULAN	ARGYLE	PETER HELMUT CHRISTIAN STOSSEL

Property Identification Number	Lot	DP	Parish	County	Owner
75	11	1016235	MARULAN	ARGYLE	DAVID FREDERICK BULLOCK, MAREE JULE BULLOCK
76	12	1016235	MARULAN	ARGYLE	GINA MAREE EDDIE
77	22	1016235	MARULAN	ARGYLE	SLAVKO PERINICH, MARGARITA PERINICH
78	13	1016235	MARULAN	ARGYLE	JOSEF KARL NEUKAM
79	21	1016235	MARULAN	ARGYLE	SLAVKO PERINICH, MARGARITA PERINICH
80	14	1016235	MARULAN	ARGYLE	CHRISTOPHER STEPHEN BROWN
81	20	1016235	MARULAN	ARGYLE	RAYMOND VELLA, CARMEN MARIA VELLA
82	15	1016235	MARULAN	ARGYLE	FRANCIS PAUL MCCARTHY
83	19	1016235	MARULAN	ARGYLE	SLAVKO PERINICH, MARGARITA PERINICH
84	18	1016235	MARULAN	ARGYLE	SLAVKO PERINICH, MARGARITA PERINICH
85	16	1016235	MARULAN	ARGYLE	AHMAD HELLOU
86	17	1016235	MARULAN	ARGYLE	KUNIBERT ANTON KRAUSE, PAMELA MARY KRAUSE
87	0	0	MARULAN	ARGYLE	CROWN LAND
88	1	1074819	MARULAN	ARGYLE	READYMIX HOLDINGS PTY LTD
89	2	1018139	MARULAN	ARGYLE	SOUTH CREEK DAIRY PTY. LIMITED
90	1	1018139	MARULAN	ARGYLE	SOUTH CREEK DAIRY PTY. LIMITED
91	1	221236	MARULAN	ARGYLE	RADOLJUB SIMONOVIC, ZIVOJIN SIMONOVIC
92	3	517713	MARULAN	ARGYLE	Owned by Tailored Property(Wilson Drive) Pty Ltd
93	6	588696	MARULAN	ARGYLE	THE COUNCIL OF THE SHIRE OF MULWAREE
94		2338-3040	MARULAN	ARGYLE	REFERENCE NOT HELD
95	111	750029	MARULAN	ARGYLE	WENDY JOY RAWSON
96	11	700579	MARULAN	ARGYLE	WENDY JOY RAWSON
97	21	700579	MARULAN	ARGYLE	THE COMMISSIONER FOR MAIN ROADS
98	20	700579	MARULAN	ARGYLE	THE COMMISSIONER FOR MAIN ROADS
99	16	700579	MARULAN	ARGYLE	GARY ARTHUR WILLIAMS
100	2	833561	MARULAN	ARGYLE	THE COUNCIL OF THE SHIRE OF MULWAREE
101	1	833561	MARULAN	ARGYLE	BP AUSTRALIA LIMITED
102	2	804586	MARULAN	ARGYLE	BP AUSTRALIA LIMITED

Property Identification Number	Lot	DP	Parish	County	Owner
103	1	804586	MARULAN	ARGYLE	THE COUNCIL OF THE SHIRE OF MULWAREE
104	PT5	791106	MARULAN	ARGYLE	FOLIO CANCELLED, RESIDUE REMAINS: BEING ROAD. NEW FOLIO HAS BEEN CREATED FOR LOT 5 IN DP803733
105	1	855762	MARULAN	ARGYLE	ANTHONY MARCELLUS DENLAY, LEA MAREE DENLAY
106	203	870194	MARULAN	ARGLE	ARGYLE PARK PROPERTIES PTY LTD, PROMOTIONS 2000 PTY LIMITED
107	1	1060897	MARULAN	ARGYLE	MULWAREE SHIRE COUNCIL
108	11	881240	MARULAN	ARGYLE	FRANK JOHN BARTOLO, PAULINE CARMEL BARTOLO
109	12	881240	MARULAN	ARGYLE	R.A. BREWER PTY. LIMITED
110	2	1060897	MARULAN	ARGYLE	RICHARD MAXWELL CLARKE, JACQUELINE ANNE CLARKE
111	3	877850	MARULAN	ARGYLE	PETER ANDREW BREWER
112	2	1004503	MARULAN	ARGYLE	BARRY DONALD ARMITT, EMILY LOUISE ARMITT
113	10	860862	MARULAN	ARGYLE	RAYMOND GARY HOLLIS, SIMONE HOLLIS
114	1	877850	MARULAN	ARGYLE	ERIC GORDON HEISE
115	6	1056566	MARULAN	ARGYLE	NOEL CAMERON ANDERSON, MAUREEN JUNE ANDERSON
116	5	1056566	MARULAN	ARGYLE	GREGORY JOHN COOPER
117	252	657522	MARULAN	ARGYLE	KHANH HUU HOANG, NGA THU NGUYEN
118	12	750029	MARULAN	ARGYLE	JOHN HOWARD DURBRIDGE, LYNDALL MARGARET DURBRIDGE
119	251	750029	MARULAN	ARGYLE	JOAN CHARLESWORTH
120	250	750029	MARULAN	ARGYLE	ANGELO PAUL COLUCCIO
121	247	750029	MARULAN	ARGYLE	ANDREW JOHN WHITLOCK, KATHRYN LORRAINE WHITLOCK
122	15	700579	MARULAN	ARGYLE	ANDREW JOHN WHITLOCK, KATHRYN LORRAINE WHITLOCK
123	246	750029	MARULAN	ARGYLE	ALFRED CACHIA, ANDREANA CACHIA
124	245	750029	MARULAN	ARGYLE	ALFRED CACHIA, ANDREANA CACHIA
125	249	750029	MARULAN	ARGYLE	YADRAN PTY LIMITED
126	263	750029	MARULAN	ARGYLE	ESTATE: PERPETUAL LEASE, GREGORY JOHN COOPER

Property Identification Number	Lot	DP	Parish	County	Owner
127	1	1056566	MARULAN	ARGYLE	GREGORY JOHN COOPER
128	2	1056566	MARULAN	ARGYLE	GRAEME ANDREW BENSON, DIANN DOREEN BENSON
129	41	1007978	MARULAN	ARGYLE	GLENN ANDREW CANTY, STEPHANIE MARTHA CANTY
130	7008	1025601	MARULAN	ARGYLE	LAND IS ADMINISTERED BY STATE LAND SERVICES
131	264	750029	MARULAN	ARGYLE	ESTATE: PERPETUAL LEASE, DOUGLAS ALLAN EIRTH
132	262	750029	MARULAN	ARGYLE	GREGORY JOHN COOPER
133	248	750029	MARULAN	ARGYLE	JEFFREY ROBERT WOODS, BARBARA RUTH WOODS
134	218	750029	MARULAN	ARGYLE	JEFFREY ROBERT WOODS, BARBARA RUTH WOODS
135	217	750029	MARULAN	ARGYLE	JEFFREY ROBERT WOODS, BARBARA RUTH WOODS
136	122	750029	MARULAN	ARGYLE	JOHN FELTHAM, SHIRLEY MARGARET FELTHAM
137	215	750029	MARULAN	ARGYLE	PEJAR LOCAL ABORIGINAL LAND COUNCIL
138	216	750029	MARULAN	ARGYLE	PEJAR LOCAL ABORIGINAL LAND COUNCIL
139	7001	1025603	MARULAN	ARGYLE	Crown Land
140		2153-3040	MARULAN	ARGYLE	Crown Land
141	0	0	MARULAN	ARGYLE	Crown Land
142	11	196132	MARULAN	ARGYLE	DCO NOMINEES PTY LIMITED (Readymix Holdings Pty Ltd)
143	10	196132	MARULAN	ARGYLE	DCO NOMINEES PTY LIMITED (Readymix Holdings Pty Ltd)
144	9	196132	MARULAN	ARGYLE	DCO NOMINEES PTY LIMITED (Readymix Holdings Pty Ltd)
145	12	196132	MARULAN	ARGYLE	DCO NOMINEES PTY LIMITED (Readymix Holdings Pty Ltd)
146	8	196132	MARULAN	ARGYLE	DCO NOMINEES PTY LIMITED (Readymix Holdings Pty Ltd)
147	7	196132	MARULAN	ARGYLE	DCO NOMINEES PTY LIMITED (Readymix Holdings Pty Ltd)
148	13	196132	MARULAN	ARGYLE	DCO NOMINEES PTY LIMITED (Readymix Holdings Pty Ltd)
149	6	196132	MARULAN	ARGYLE	DCO NOMINEES PTY LIMITED (Readymix Holdings Pty Ltd)
150	5	196132	MARULAN	ARGYLE	DCO NOMINEES PTY LIMITED (Readymix Holdings Pty Ltd)
151	14	196132	MARULAN	ARGYLE	DCO NOMINEES PTY LIMITED (Readymix Holdings Pty Ltd)
152	4	196132	MARULAN	ARGYLE	DCO NOMINEES PTY LIMITED (Readymix Holdings Pty Ltd)
153	3	196132	MARULAN	ARGYLE	DCO NOMINEES PTY LIMITED (Readymix Holdings Pty Ltd)
154	15	196132	MARULAN	ARGYLE	DCO NOMINEES PTY LIMITED (Readymix Holdings Pty Ltd)

Property Identification Number	Lot	DP	Parish	County	Owner
155	2	196132	MARULAN	ARGYLE	DCO NOMINEES PTY LIMITED (Readymix Holdings Pty Ltd)
156	1/8	758653	MARULAN	ARGYLE	THE STATE OF NEW SOUTH WALES
157	10	111641	MARULAN	ARGYLE	DCO NOMINEES PTY LIMITED (Readymix Holdings Pty Ltd)
158	5/12	758653	MARULAN	ARGYLE	READYMIX HOLDINGS PTY LTD
159	4/12	758653	MARULAN	ARGYLE	READYMIX HOLDINGS PTY LTD
160	3/12	758653	MARULAN	ARGYLE	READYMIX HOLDINGS PTY LTD
161	2/12	758653	MARULAN	ARGYLE	READYMIX HOLDINGS PTY LTD
162	1/12	758653	MARULAN	ARGYLE	READYMIX HOLDINGS PTY LTD
163	6/7	758653	MARULAN	ARGYLE	READYMIX HOLDINGS PTY LTD
164	5/7	758653	MARULAN	ARGYLE	READYMIX HOLDINGS PTY LTD
165	4/7	758653	MARULAN	ARGYLE	READYMIX HOLDINGS PTY LTD
166	3/7	758653	MARULAN	ARGYLE	READYMIX HOLDINGS PTY LTD
167	2/7	758653	MARULAN	ARGYLE	READYMIX HOLDINGS PTY LTD
168	1/7	758653	MARULAN	ARGYLE	READYMIX HOLDINGS PTY LTD
169	9/7	758653	MARULAN	ARGYLE	READYMIX HOLDINGS PTY LTD
170	8/7	758653	MARULAN	ARGYLE	READYMIX HOLDINGS PTY LTD
171	7/7	758653	MARULAN	ARGYLE	READYMIX HOLDINGS PTY LTD
172	11	111641	MARULAN	ARGYLE	DCO NOMINEES PTY LIMITED (Readymix Holdings Pty Ltd)
173	14	797340	MARULAN	ARGYLE	DCO NOMINEES PTY LIMITED (Readymix Holdings Pty Ltd)
174	2	214304	MARULAN	ARGYLE	JOHN FELTHAM, SHIRLEY MARGARET FELTHAM
175	1	214304	MARULAN	ARGYLE	ROADS AND TRAFFIC AUTHORITY OF NEW SOUTH WALES
176	13	797340	MARULAN	ARGYLE	DCO NOMINEES PTY LIMITED (Readymix Holdings Pty Ltd)
177	PT8/1	758653	MARULAN	ARGYLE	JOHN FELTHAM, SHIRLEY MARGARET FELTHAM
178	PT7/1	758653	MARULAN	ARGYLE	ROADS AND TRAFFIC AUTHORITY OF NEW SOUTH WALES
179	12	797340	MARULAN	ARGYLE	DCO NOMINEES PTY LIMITED (Readymix Holdings Pty Ltd)
180	11	797340	MARULAN	ARGYLE	DCO NOMINEES PTY LIMITED (Readymix Holdings Pty Ltd)
181	10	797340	MARULAN	ARGYLE	DCO NOMINEES PTY LIMITED (Readymix Holdings Pty Ltd)

Property Identification Number	Lot	DP	Parish	County	Owner
182	9	797340	MARULAN	ARGYLE	DCO NOMINEES PTY LIMITED (Readymix Holdings Pty Ltd)
183	8	797340	MARULAN	ARGYLE	DCO NOMINEES PTY LIMITED (Readymix Holdings Pty Ltd)
184	7	797340	MARULAN	ARGYLE	DCO NOMINEES PTY LIMITED (Readymix Holdings Pty Ltd)
185	7002	1025604	MARULAN	ARGYLE	Crown Land
186	6	797340	MARULAN	ARGYLE	DCO NOMINEES PTY LIMITED (Readymix Holdings Pty Ltd)
187	5	797340	MARULAN	ARGYLE	DCO NOMINEES PTY LIMITED (Readymix Holdings Pty Ltd)
188	4	797340	MARULAN	ARGYLE	DCO NOMINEES PTY LIMITED (Readymix Holdings Pty Ltd)
189	3	797340	MARULAN	ARGYLE	DCO NOMINEES PTY LIMITED (Readymix Holdings Pty Ltd)
190	2	797340	MARULAN	ARGYLE	DCO NOMINEES PTY LIMITED (Readymix Holdings Pty Ltd)
191	1	797340	MARULAN	ARGYLE	DCO NOMINEES PTY LIMITED (Readymix Holdings Pty Ltd)
192	4/5	758653	MARULAN	ARGYLE	DCO NOMINEES PTY LIMITED (Readymix Holdings Pty Ltd)
193	3/5	758653	MARULAN	ARGYLE	DCO NOMINEES PTY LIMITED (Readymix Holdings Pty Ltd)
194	2/5	758653	MARULAN	ARGYLE	DCO NOMINEES PTY LIMITED (Readymix Holdings Pty Ltd)
195	1/5	758653	MARULAN	ARGYLE	Crown Land
196	10/10	7586653	MARULAN	ARGYLE	Crown Land
197	7003	1025602	MARULAN	ARGYLE	Crown Land
198	5/3	758653	MARULAN	ARGYLE	REFERENCE NOT HELD
199	6/3	758653	MARULAN	ARGYLE	REFERENCE NOT HELD
200	4/3	758653	MARULAN	ARGYLE	REFERENCE NOT HELD
201	7/3	758653	MARULAN	ARGYLE	REFERENCE NOT HELD
202	3/3	758653	MARULAN	ARGYLE	REFERENCE NOT HELD
203	8/3	758653	MARULAN	ARGYLE	REFERENCE NOT HELD
204	2/3	758653	MARULAN	ARGYLE	REFERENCE NOT HELD
205	9/3	758653	MARULAN	ARGYLE	COMPUTER FOLIO NOT CREATED, PART OF LAND IN VOL 100 FOL 250
206	1/3	758653	MARULAN	ARGYLE	REFERENCE NOT HELD
207	10/3	758653	MARULAN	ARGYLE	COMPUTER FOLIO NOT CREATED, PART OF LAND IN VOL 100 FOL 250
208	0	0	MARULAN	ARGYLE	Crown Land

Property Identification Number	Lot	DP	Parish	County	Owner
209	1	827410	MARULAN	ARGYLE	DIANE MARY TOMKINS
210	6/6	758653	MARULAN	ARGYLE	DIANE MARY TOMKINS
211	5/6	758653	MARULAN	ARGYLE	DIANE MARY TOMKINS
212	4/6	758653	MARULAN	ARGYLE	DIANE MARY TOMKINS
213	3/6	758653	MARULAN	ARGYLE	DIANE MARY TOMKINS
214	2/6	758653	MARULAN	ARGYLE	DIANE MARY TOMKINS
215	1/6	758653	MARULAN	ARGYLE	DIANE MARY TOMKINS
216	10/9	758653	MARULAN	ARGYLE	COMPUTER FOLIO NOT CREATED
217	9/9	758653	MARULAN	ARGYLE	COMPUTER FOLIO NOT CREATED
218	8/9	758653	MARULAN	ARGYLE	COMPUTER FOLIO NOT CREATED
219	7/9	758653	MARULAN	ARGYLE	COMPUTER FOLIO NOT CREATED
220	6/9	758653	MARULAN	ARGYLE	COMPUTER FOLIO NOT CREATED
221	5/9	758653	MARULAN	ARGYLE	COMPUTER FOLIO NOT CREATED
222	4/9	758653	MARULAN	ARGYLE	THE ROMAN CATHOLIC CHURCH FOR THE DIOCESE OF GOULBURN (AP C535777)
223	3/9	758653	MARULAN	ARGYLE	THE ROMAN CATHOLIC CHURCH FOR THE DIOCESE OF GOULBURN (AP C535777)
224	2/9	758653	MARULAN	ARGYLE	THE TRUSTEES OF THE ROMAN CATHOLIC CHURCH FOR THE DIOCESE OF GOULBURN
225	1/9	758653	MARULAN	ARGYLE	THE TRUSTEES OF THE ROMAN CATHOLIC CHURCH FOR THE DIOCESE OF GOULBURN
226	19/9	758653	MARULAN	ARGYLE	JOHN FELTHAM, SHIRLEY MARGARET FELTHAM
227	20/9	758653	MARULAN	ARGYLE	JOHN FELTHAM, SHIRLEY MARGARET FELTHAM
228	18/9	758653	MARULAN	ARGYLE	JOHN FELTHAM, SHIRLEY MARGARET FELTHAM
229	17/9	758653	MARULAN	ARGYLE	JOHN FELTHAM, SHIRLEY MARGARET FELTHAM
230	16/9	758653	MARULAN	ARGYLE	JOHN FELTHAM
231	15/9	758653	MARULAN	ARGYLE	JOHN FELTHAM, SHIRLEY MARGARET FELTHAM
232	14/9	758653	MARULAN	ARGYLE	JOHN FELTHAM, SHIRLEY MARGARET FELTHAM
233	13/9	758653	MARULAN	ARGYLE	JOHN FELTHAM, SHIRLEY MARGARET FELTHAM

Property Identification Number	Lot	DP	Parish	County	Owner
234	12/9	758653	MARULAN	ARGYLE	JOHN FELTHAM, SHIRLEY MARGARET FELTHAM
235	11/9	758653	MARULAN	ARGYLE	JOHN FELTHAM, SHIRLEY MARGARET FELTHAM
236	10/6	758653	MARULAN	ARGYLE	DIANE MARY TOMKINS
237	9/6	758653	MARULAN	ARGYLE	DIANE MARY TOMKINS
238	7/6	758653	MARULAN	ARGYLE	DIANE MARY TOMKINS
239	8/6	758653	MARULAN	ARGYLE	DIANE MARY TOMKINS
240	16/2	758653	MARULAN	ARGYLE	REFERENCE NOT HELD
241	17/2	758653	MARULAN	ARGYLE	REFERENCE NOT HELD
242	18/2	758653	MARULAN	ARGYLE	REFERENCE NOT HELD
243	13/2	758653	MARULAN	ARGYLE	REFERENCE NOT HELD
244	14/2	758653	MARULAN	ARGYLE	REFERENCE NOT HELD
245	15/2	758653	MARULAN	ARGYLE	REFERENCE NOT HELD
246	9/4	758653	MARULAN	ARGYLE	THE CHURCH OF ENGLAND PROPERTY TRUST DIOCESE OF GOULBURN
247	8/4	758653	MARULAN	ARGYLE	THE CHURCH OF ENGLAND PROPERTY TRUST DIOCESE OF GOULBURN
248	7/4	758653	MARULAN	ARGYLE	THE CHURCH OF ENGLAND PROPERTY TRUST DIOCESE OF GOULBURN
249	1/4	758653	MARULAN	ARGYLE	GREGORY JOHN COOPER
250	2/4	758653	MARULAN	ARGYLE	GREGORY JOHN COOPER
251	3/4	758653	MARULAN	ARGYLE	GREGORY JOHN COOPER
252	4/4	758653	MARULAN	ARGYLE	GREGORY JOHN COOPER
253	5/4	758653	MARULAN	ARGYLE	GREGORY JOHN COOPER
254	6/4	758653	MARULAN	ARGYLE	GREGORY JOHN COOPER
255	2	630995	MARULAN	ARGYLE	ALFREDO ZAMATTIA, NANCY ZAMATTIA
256	3	630995	MARULAN	ARGYLE	PETER ELETER
257	1	630995	MARULAN	ARGYLE	NGEE KAR FUN
258	42	1007978	MARULAN	ARGYLE	RODNEY VEIGEL, MARGARET EVELYN VEIGEL
259	5	631680	MARULAN	ARGYLE	MINH QUANG, ANN CHI QUANG

Property Identification Number	Lot	DP	Parish	County	Owner
260	6	631680	MARULAN	ARGYLE	DAVID ANDREW MURPHY, MERRILYN LEE MURPHY, ALLAN ROBERT MURPHY, CAROLYN MARY MURPHY
261	238	750029	MARULAN	ARGYLE	GEORGE KYRITSIS, CATHERINA KYRITSIS
262	227	750029	MARULAN	ARGYLE	MARK GORDON BREUST, MEGAN ANN BREUST
263	3	633411	MARULAN	ARGYLE	KINDERA PTY. LIMITED
264	2	633411	MARULAN	ARGYLE	DENNIS GOUSKOS, MARIA GOUSKOS
265	1	633411	MARULAN	ARGYLE	RAFFAELE GIOIELLO, NELLY GIOIELLO
266	4	561615	MARULAN	ARGYLE	DAVID OSBOURN YOUNG, AGNES TEMPLEMAN INGLIS YOUNG, PHILIP SCOTT YOUNG
267	139	750029	MARULAN	ARGYLE	JOHN FELTHAM
268	208	750029	MARULAN	ARGYLE	MOOROOWOLEN PASTORAL PTY LIMITED
269	75	750029	MARULAN	ARGYLE	KEVIN JAMES BLACKWELL
270	2	559473	MARULAN	ARGYLE	ALLAN GEORGE COSTA
271	1	559473	MARULAN	ARGYLE	PETER HANNA
272	5	1040940	MARULAN	ARGYLE	ROADS AND TRAFFIC AUTHORITY OF NEW SOUTH WALES
273	3	561615	MARULAN	ARGYLE	PETER HANNA
274	1	602775	BILLYRAMBIJA	ARGYLE	BERYL MAUD DUCKSBURY, HARRY COLIN METTAM, GLADYS METTAM
275	2	602775	BILLYRAMBIJA	ARGYLE	NEWBALL PTY LIMITED
276	88	750003	BILLYRAMBIJA	ARGYLE	NEWBALL PTY LIMITED
277	3	750003	BILLYRAMBIJA	ARGYLE	NEWBALL PTY LIMITED
278	91	750003	BILLYRAMBIJA	ARGYLE	NEWBALL PTY LIMITED
279	86	750003	BILLYRAMBIJA	ARGYLE	NEWBALL PTY LIMITED